

Volumetric Rotary Piston Dry Dial Plastic Water Meter  
MODEL: LXHG-15S-20S

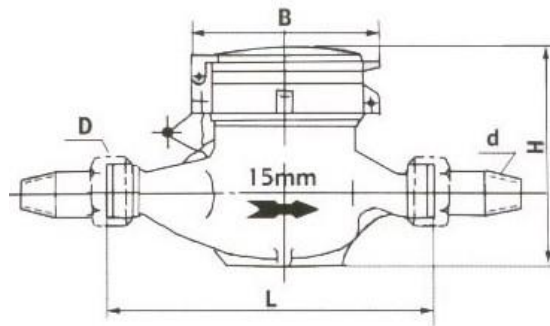

**APPLICATION:**

- ◆ Measuring the volume of cold potable water passing through the pipeline.

**FEATURES:**

- ◆ Completely plastic shell, solid and robust design, long service guaranteed.
- ◆ High quality materials fiberglass reinforced polymerization amine, corrosion resistance.
- ◆ Pole ring magnet polymer coating as protection against deposits.
- ◆ The measuring mechanism can be exchanged.
- ◆ Anti-magnet.
- ◆ Large measuring range high flow accuracy.
- ◆ Steady curve characteristics.
- ◆ Any position installation
- ◆ Measuring accuracy is up to ISO4064, Class D.

**WORKING CONDITION:**

- ◆ Water temperature:  $\leq 50^{\circ}\text{C}$
- ◆ Water pressure:  $\leq 10$  bar (16 bar on request)

**MAXIMUM PERMISSIBLE ERROR:**

- ◆ In the lower zone from  $q_{\min}$  inclusive up to but excluding  $q_t$  is  $\pm 5\%$
- ◆ In the upper zone from  $q_t$  inclusive up to and including  $q_s$  is  $\pm 2\%$

**ACCESSORIES**

**Optional: Both brass thread connections and plastic thread connections are available.**

| Type     | Size<br>(mm) | Class | $q_s$<br>Max.Flow     | $q_p$<br>Nominal<br>Flow | $q_t$<br>Transitional<br>Flow | $q_{\min}$<br>Min.<br>Flow | Min.Reading  | Max.Reading |
|----------|--------------|-------|-----------------------|--------------------------|-------------------------------|----------------------------|--------------|-------------|
|          |              |       | $\text{m}^3/\text{h}$ |                          | $\text{L/h}$                  |                            | $\text{m}^3$ |             |
| LXHG-15S | 15           | C     | 3                     | 1.5                      | 22.5                          | 15.0                       | 0.0001       | 99999       |
|          |              | D     |                       |                          | 17.25                         | 11.25                      |              |             |
| LXHG-20S | 20           | C     | 5                     | 2.5                      | 37.5                          | 25                         | 0.0001       | 99999       |
|          |              | D     |                       |                          | 28.75                         | 18.75                      |              |             |

**NINGBO AIMEI METER MANUFACTURE CO., LTD.**

**Address:** 68 Western Town Road Shangtian Town Fenghua City Zhejiang China-315511

Tel: ++86-574-88637838

Fax: ++86-574-88637968

Email: [chinaaimei@vip.163.com](mailto:chinaaimei@vip.163.com)

Alternative: [aimei@chinaaimei.com](mailto:aimei@chinaaimei.com)

| Type     | Size | L       | B  | H   | Connection Thread | Weight |
|----------|------|---------|----|-----|-------------------|--------|
| LXHG-15S | 15   | 165/190 | 99 | 108 | G3/4B             | 0.5kg  |
| LXHG-20S | 20   | 190     | 99 | 108 | G1B               | 0.7kg  |

Flow Error Curve

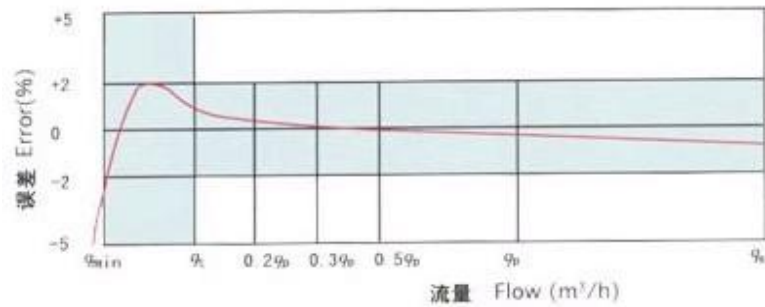

Head Loss Curve

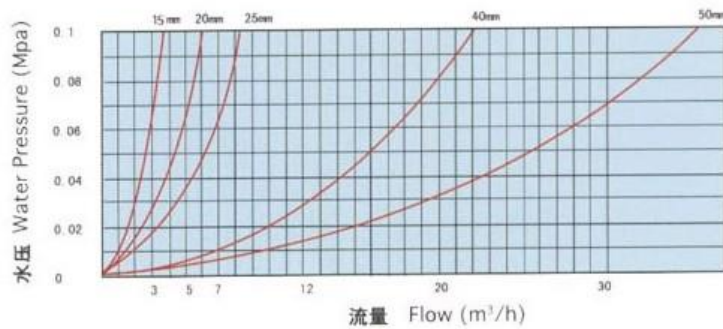

---

**NINGBO AIMEI METER MANUFACTURE CO., LTD.**

**Address:** 68 Western Town Road Shangtian Town Fenghua City Zhejiang China-315511

Tel: ++86-574-88637838

Fax: ++86-574-88637968

Email: [chinaaimei@vip.163.com](mailto:chinaaimei@vip.163.com)

Alternative: [aimei@chinaaimei.com](mailto:aimei@chinaaimei.com)