MULTI-JET DRY TYPE WATER METER

MODEL: LXSG-15E-2



APPLICATION

This range of water meter is used to measure the total quantity of cold potable water which consumed in household or a resident unit, passing through the pipeline.

FEATURES

This is a dry-type water meter. Its counting and measuring devices are driven by magnetic coupling. It is characterized by easy reading, good antifreezing property and ability to permanently keep the reading clear.

WORKING CONDITION

Water temperature: ≤ 50 for cold water meter

Water pressure: $\leq 1\text{MPa}$ or 1.6MPa optional

MAXIMUM PERMISSIBLE ERROR

In the lower zone from Q_{\min} inclusive up to but excluding Q_t is $\pm 5\%$ _ In the upper zone from Q_t

inclusive up to and including Q_s is: cold water meter $\pm 2\%$, hot water meter $\pm 3\%$.

NOTE

Technical data conform to International Standard ISO4064

NINGBO AIMEI METER MANUFACTURE CO., LTD.

Address: 68 Western Town Road Shangtian Town Fenghua City Zhejiang China-315511

Tel: +86-574-88637838

Fax: +86-574-88637968

Email: aimei@chinaaimei.com

MAIN TECHNICAL DATA

Type	Size (mm)	Class	Qn Max. Flow	Qp Nominal Flow	Qn Transitional Flow	Qmin Min. Flow	Min. Reading	Max. Reading
			M³/h		L/h		M³	
LXSG-15E-2	15	B	3	1.5	120	30	0.0001	99999

ACCESSORIES

Each water meter has one set couplings optional: 2pcs tube, 2pcs nut and 2pcs gasket.

DIMENSIONS AND WEIGHT

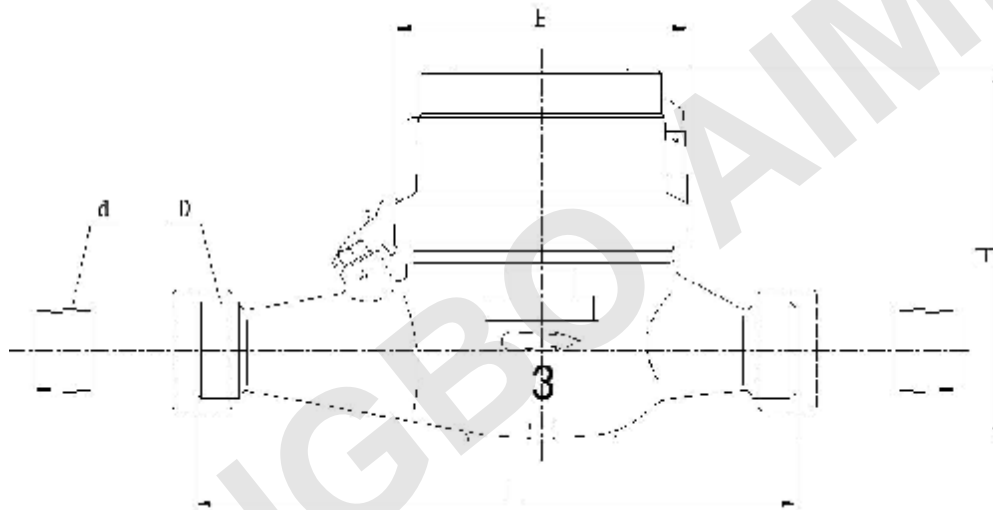

Type	Size	Length	Width	Height	Connecting Thread D	Weight (kg)
	mm					
LXSG-15E-2	15	165	99	104	G 3/4B	1.4/1.6

NINGBO AIMEI METER MANUFACTURE CO., LTD.

Address: 68 Western Town Road Shangtian Town Fenghua City Zhejiang China-315511

Tel: +86-574-88637838

Fax: +86-574-88637968

Email: aimei@chinaaimei.com

FLOW ERROR CURVE

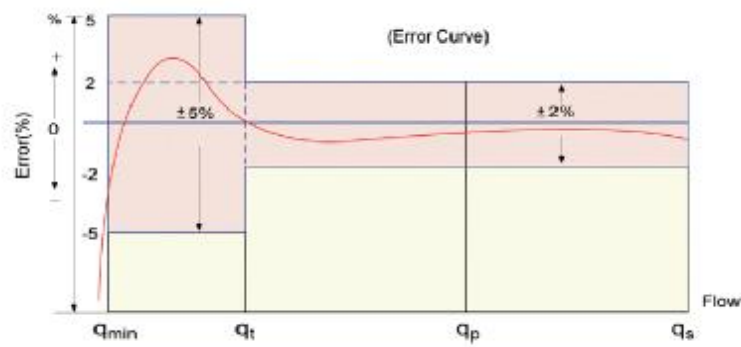

PRESSURE LOSS CURVE

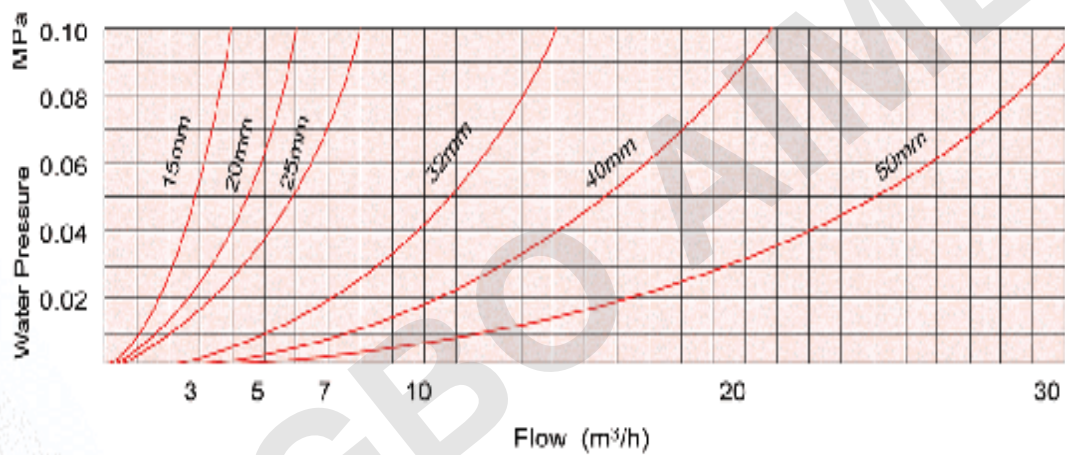

NINGBO AIMEI METER MANUFACTURE CO., LTD.

Address: 68 Western Town Road Shangtian Town Fenghua City Zhejiang China-315511

Tel: +86-574-88637838

Fax: +86-574-88637968

Email: aimei@chinaaimei.com